



Village of Lombard

Building Division / Community Development Department
255 E. Wilson Avenue, Lombard, IL 60148
Tel: 630-620-5750 Fax: 630-629-2374

A/C Condenser Requirements

A Plat of Survey is required with all AC Permit Applications

Inspections Requirements: A final inspection is required after the installation of the A/C Condenser.

-Property Line

-Required rear yard (25' In R2). New or replacement AC's shall not encroach further than 10' into required rear yard.

-Required side yards (6' or 9' in R2) New AC's cannot encroach into required side yards. Replacement AC's cannot encroach further into Required side yard than previous unit.

-Required front yards (30' in R2) AC's shall not encroach into required front yards.

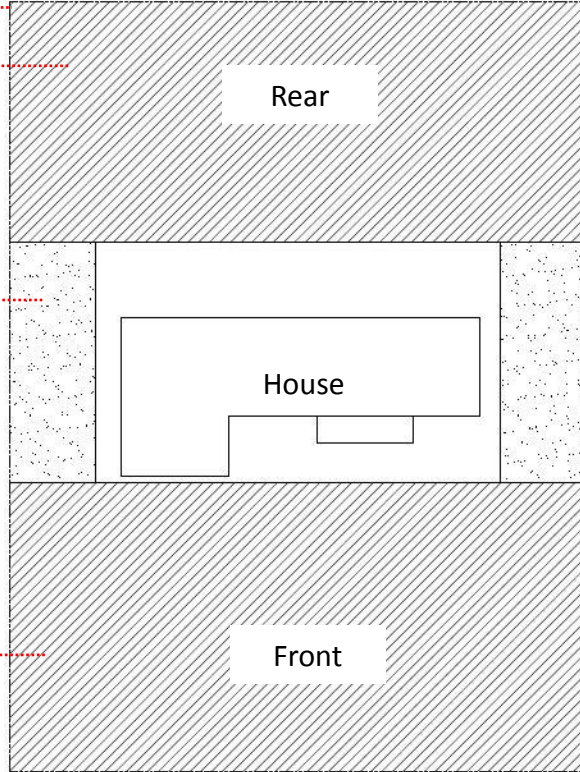

The location of the AC unit shall not block any drainage so as to adversely impact the property or adjacent properties.

Disconnecting means must be located within sight of appliance and exterior rated.

Working clearances for disconnect switch shall be not less than 36 inches in depth, measured from front of disconnect. In addition the width of such equipment shall not be less than 30 inches wide, measured from front of disconnect. **Working clearance** for a/c unit or heat pump shall be 24 inches on the sides, 30 inches in front & 12 inches in the rear. **Location** depends on zoning ordinance. **NOTE:** The circuit breaker must be labeled for the type of appliance. Also, circuit breaker must be an approved type for the load center and be the size marked on the appliance.

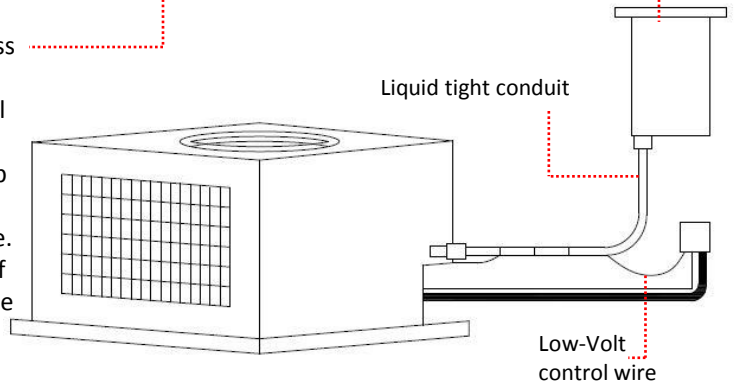

If you have any questions, or to schedule an inspections, please contact the Building Division at 630-620-5750 or email buildingdivision@villageoflombard.org